



Chelmer Road, London, E9

BUTLER & STAG



Substantial four bedroom end of terrace house situated in close proximity to the vibrant Chatsworth Road and Homerton overground station.



- Four Double Bedrooms
- Three Bathrooms
- Chatsworth Road Location
- Unfurnished
- End of Terrace House
- Private Rear Garden
- Close to Homerton Station
- Available from 4th September 2025

Featuring four double bedrooms and three bathrooms, this spacious house would be the perfect home for four professional sharers. The accommodation further comprises of a large reception opening out onto a private garden, a separate fitted kitchen and additional WC.

The location is second to none, with a wide range of amenities, Victoria Park and Hackney Central all within easy reach.

Offered unfurnished and available from early September 2025.

EPC Rating C
Council Tax Band E

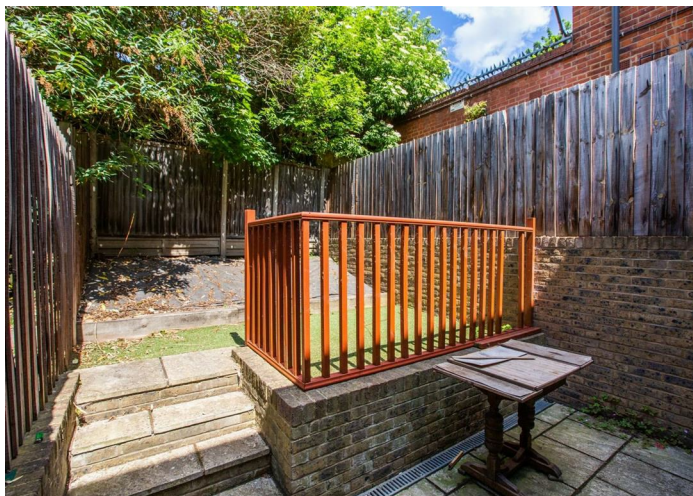



Chelmer Road

Approx. Gross Internal Area 125 Sq M (1346 Sq Ft)

BUTLER & STAG



Ground Floor
Approx. 45 Sq. meters (489 Sq. feet)

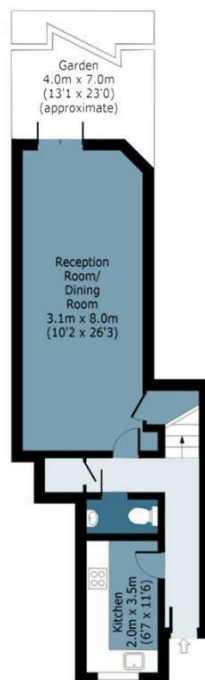

First Floor
Approx. 42 Sq. meters (449 Sq. feet)

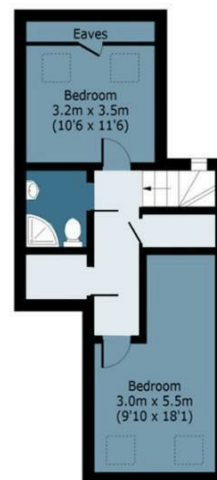

Measurements are approximate and for illustration purposes only. While we do not doubt the accuracy and completeness, we advise you conduct a careful independent assessment of the property to determine monetary value.
© @modephoto.uk www.modephoto.co.uk

BUTLER & STAG

☎ 020 8102 1236

🏠 508 Roman Road, Bow, London, E3 5LU

✉ bow@butlerandstag.com

www.butlerandstag.uk

IMPORTANT NOTICE - These particulars have been prepared in good faith and they are not intended to constitute part of an offer or contract. We have not performed a structural survey on this property and the services, appliances and specific fittings have not been tested. All photographs, measurements, floor plans and distances referred to are given as a guide and should not be relied upon.